



WALRUS PUMP

TPK Series  
Immersible Pumps



TPK 4T3-3

### Applications

The WALRUS TPK Series is vertical multistage centrifugal pump, designed for industrial use, specially for machine tools, to carry fluids such as water, coolant, light oil and other clean, non aggressive matters.

- Industrial circulation system
- Washing/cleaning system
- Filtration system

### Pump construction

Submersible vertical multistage centrifugal pump, self-priming, stub pump shaft per coupling connect with motor. Main working parts made by stainless steel.

### Motor

Enclosure class : IP54

Insulation class : F.

Nominal speed : 2900 / 3500 rpm

Frequency range : 50 / 60 Hz

Voltages Code:

Code	PH	50Hz	60Hz
3Q	3	200-240/380-440V	-
3Z*	3	200-255/380-440V	200-255/380-480V
4U*	3	200-240/380-415V	200-240/380-440V

\* The motor can be use in both 50/60 hz.

### Operation conditions

Ambient temperature :Max. +40°C

Liquid temperature range :+0°C ~ +90°C

Operating pressure :Max. 10 kg/cm<sup>2</sup>

Submerged depth :Min. 65mm

### Model code

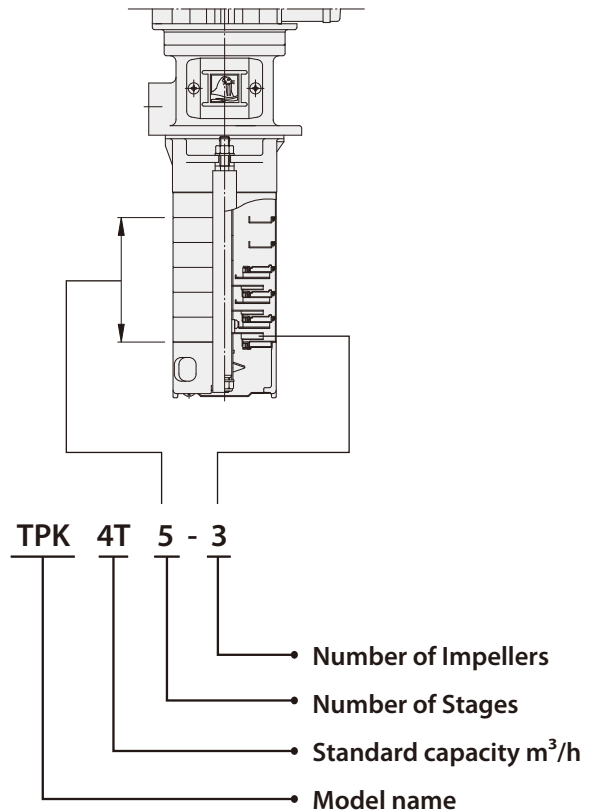

### Performance range

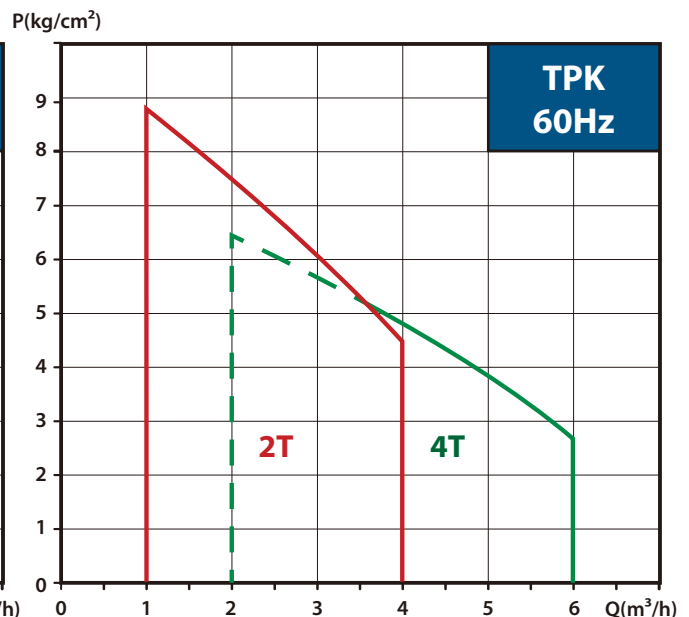
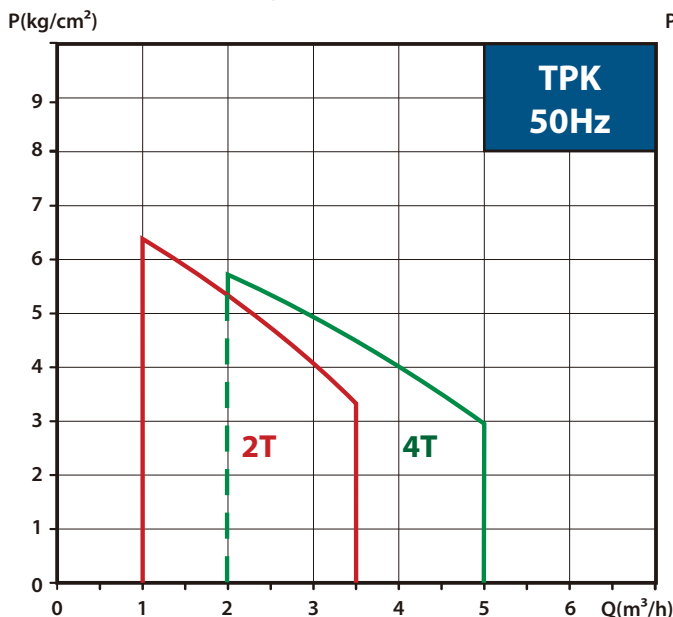

### Sectional drawing

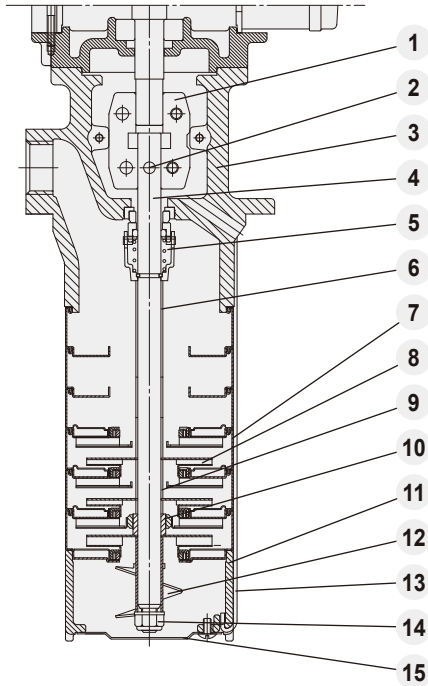

### Materials

No.	Part name	Material
1	Coupling	SUS 304
2	Shaft pin	SUS 304
3	Pump head	FCD 45
4	Shaft	SUS 304
5	Mechanical Seal	HTTH
6	Sleeve	SUS 304
7	Intermediate chamber	SUS 304
8	Impeller	SUS 304
9	Sleeve (impeller)	SUS 304
10	Bearing ring	Tungsten Carbide
11	Suction interconnector	SUS 304
12	Priming screw	SUS 304
13	Strap	SUS 304
14	Lock Nut	SUS 316
15	Filter	SUS 304

### Options on request

- Special mechanical seal

Mechanical seal type	Material	
	Stationary Face/ Rotary Face	Cup Gasket & O Ring
HTTH HTTV HTTE	(T)Tungsten Carbide/ (T)Tungsten Carbide	(H) HNBR (V) Viton (E) EPDM
HSSH HSSV HSSE	(S)Silicium carbide/ (S)Silicium carbide	
HGSH HGSV HGSE	(G)Carbon/ (S)Silicium carbide	

## Performance curves

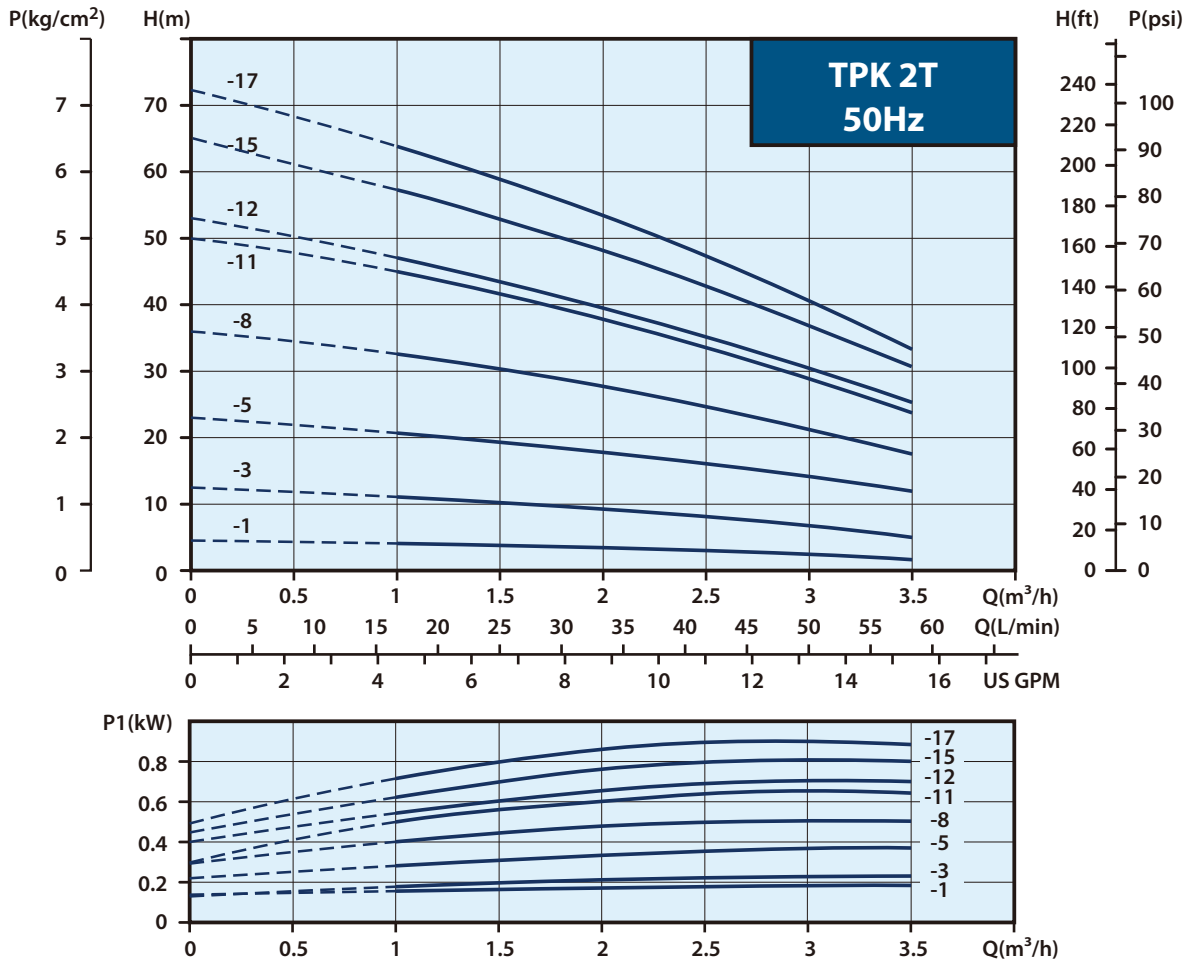

## Electrical data

Standard Model	Phase (Ø)	voltage code	Cycle (Hz)	Volts (V)	Input Power (W)	Input Ampere (A)
TPK 2T 3 - 1	3	3Z	50	200-255 / 380-440	220	0.9 / 0.6
			60	200-255 / 380-480	280	0.9 / 0.6
TPK 2T 3 - 3	3	3Z	50	200-255 / 380-440	280	0.9 / 0.7
			60	200-255 / 380-480	370	1.1 / 0.6
TPK 2T 5 - 5	3	3Z	50	200-255 / 380-440	450	2.6 / 1.5
			60	200-255 / 380-480	600	2.2 / 1.5
TPK 2T 8 - 8	3	3Z	50	200-255 / 380-440	580	2.9 / 1.7
			60	200-255 / 380-480	820	2.7 / 1.6
TPK 2T 11-11	3	3Z	50	200-255 / 380-440	700	3.2 / 1.8
			60	200-255 / 380-480	1050	3.5 / 1.9
TPK 2T 12-12	3	3Z	50	200-255 / 380-440	780	3.5 / 1.9
			60	200-255 / 380-480	1160	3.6 / 2.0
TPK 2T 15-15	3	4U	50	200-240 / 380-415	850	3.0 / 1.8
			60	200-240 / 380-440	1300	4.1 / 2.3
TPK 2T 17-17	3	4U	50	200-240 / 380-415	950	3.6 / 2.1
			60	200-240 / 380-440	1450	5.0 / 2.7

Maximum 19 Stages

## Performance curves

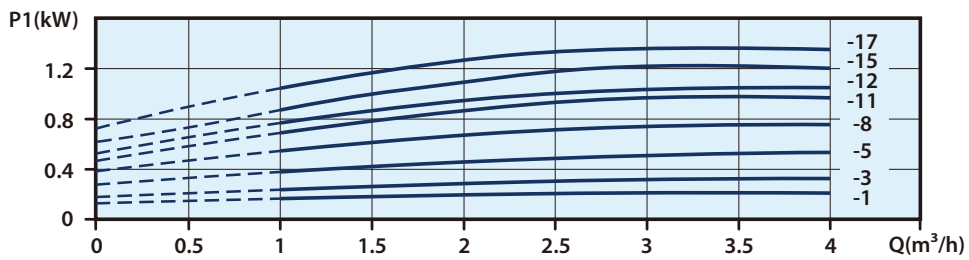
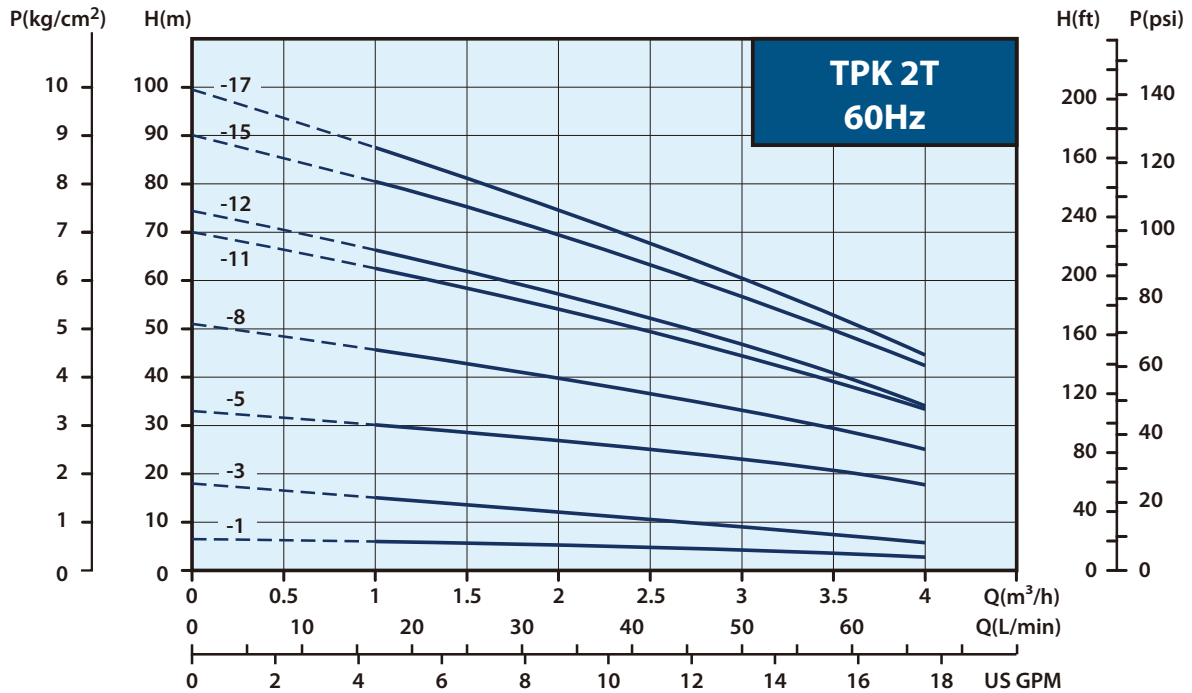

## Dimensions

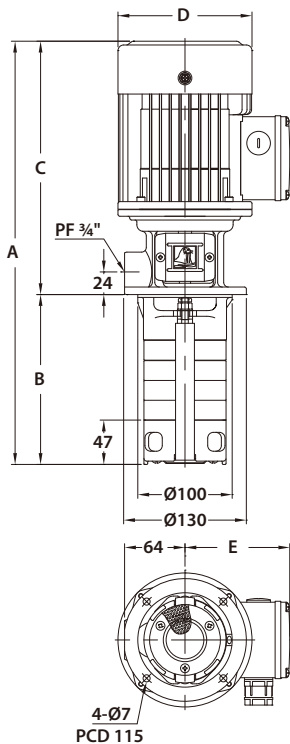

Model	A (mm)	B (mm)	C (mm)	D (mm)	E (mm)	N.W.(kg)
TPK2T 5 - 1	480	222	258	123	99	8.7
TPK2T 3 - 3	438	180	258	123	99	8.7
TPK2T 5 - 3	480	222	258	123	99	8.9
TPK2T 8 - 3	543	285	258	123	99	9.2
TPK2T 11 - 3	606	348	258	123	99	9.6
TPK2T 5 - 5	490	222	268	142	111	12.1
TPK2T 8 - 5	553	285	268	142	111	12.4
TPK2T 10 - 5	595	327	268	142	111	12.6
TPK2T 11 - 5	616	348	268	142	111	12.7
TPK2T 15 - 5	700	432	268	142	111	13.0
TPK2T 8 - 8	553	285	268	142	111	12.7
TPK2T 11 - 8	616	348	268	142	111	13.0
TPK2T 11-11	656	348	308	142	111	14.3
TPK2T 15-12	740	432	308	142	111	14.5
TPK2T 15-15	740	432	308	142	111	15.0
TPK2T 19-15	824	516	308	142	111	15.4
TPK2T 19-17	824	516	308	142	111	15.8

## Performance curves

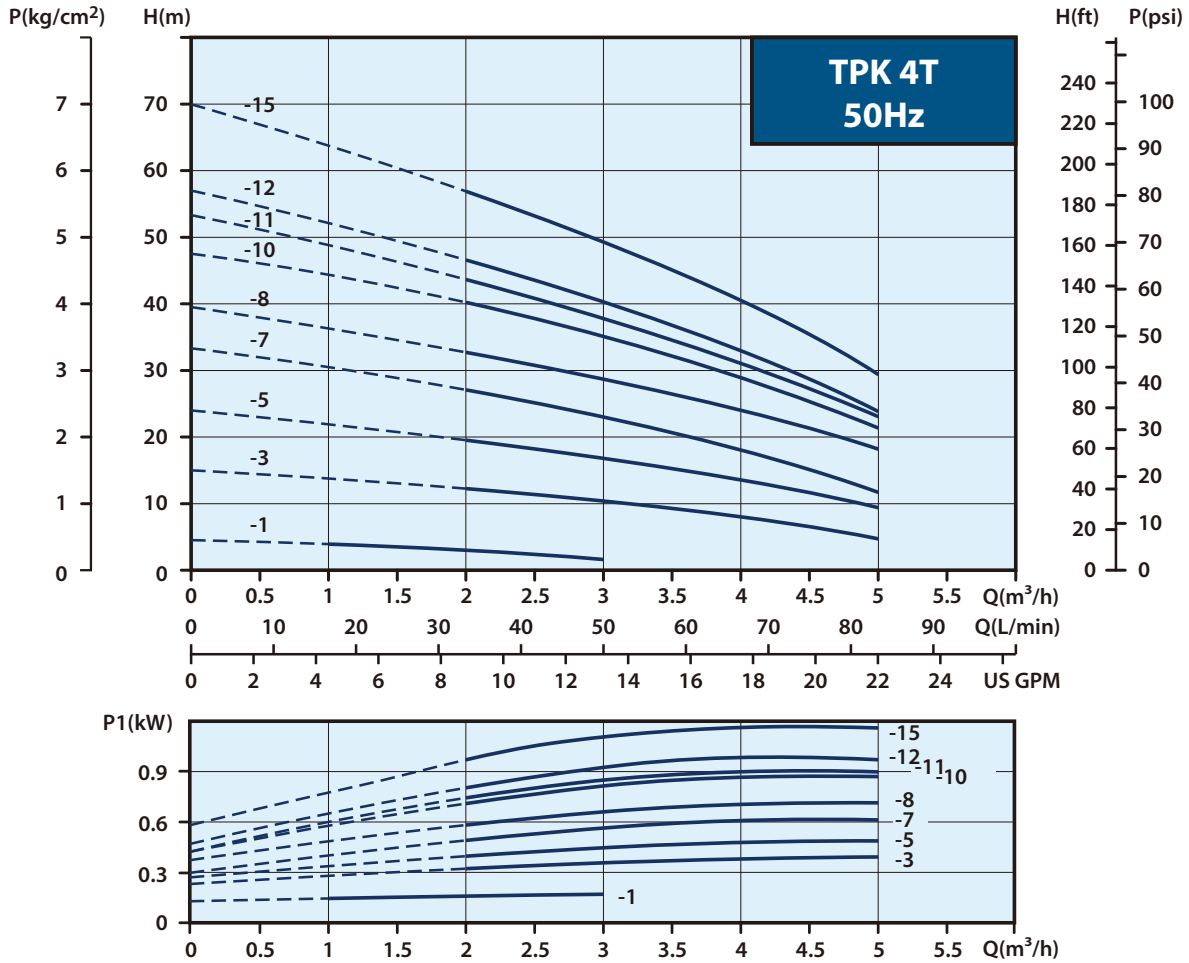

## Electrical data

Standard Model	Phase (Ø)	voltage code	Cycle (Hz)	Volts (V)	Input Power (W)	Input Ampere (A)
TPK 4T 3 - 1	3	3Z	50	200-255 / 380-440	250	1.0 / 0.6
			60	200-255 / 380-480	300	1.0 / 0.6
TPK 4T 3 - 3	3	3Z	50	200-255 / 380-440	430	2.8 / 1.4
			60	200-255 / 380-480	550	2.2 / 1.2
TPK 4T 5 - 5	3	3Z	50	200-255 / 380-440	580	2.9 / 1.7
			60	200-255 / 380-480	900	2.7 / 1.6
TPK 4T 7 - 7	3	3Z	50	200-255 / 380-440	680	3.2 / 1.8
			60	200-255 / 380-480	1000	3.4 / 1.9
TPK 4T 8 - 8	3	3Z	50	200-255 / 380-440	750	3.5 / 1.9
			60	200-255 / 380-480	1160	3.6 / 2.0
TPK 4T 10-10	3	3Z	50	200-255 / 380-440	900	4.7 / 2.6
			60	200-255 / 380-480	1420	4.7 / 2.6
TPK 4T 11-11	3	4U	50	200-240 / 380-415	950	3.6 / 2.1
			60	200-240 / 380-440	1450	5.0 / 2.7
TPK 4T 12-12	3	4U	50	200-240 / 380-415	1050	3.9 / 2.3
			60	200-240 / 380-440	1580	5.3 / 2.9
TPK 4T 15-15	3	3Q	50	200-240 / 380-440	1300	4.4 / 2.8

Maximum 19 Stages

## Performance curves

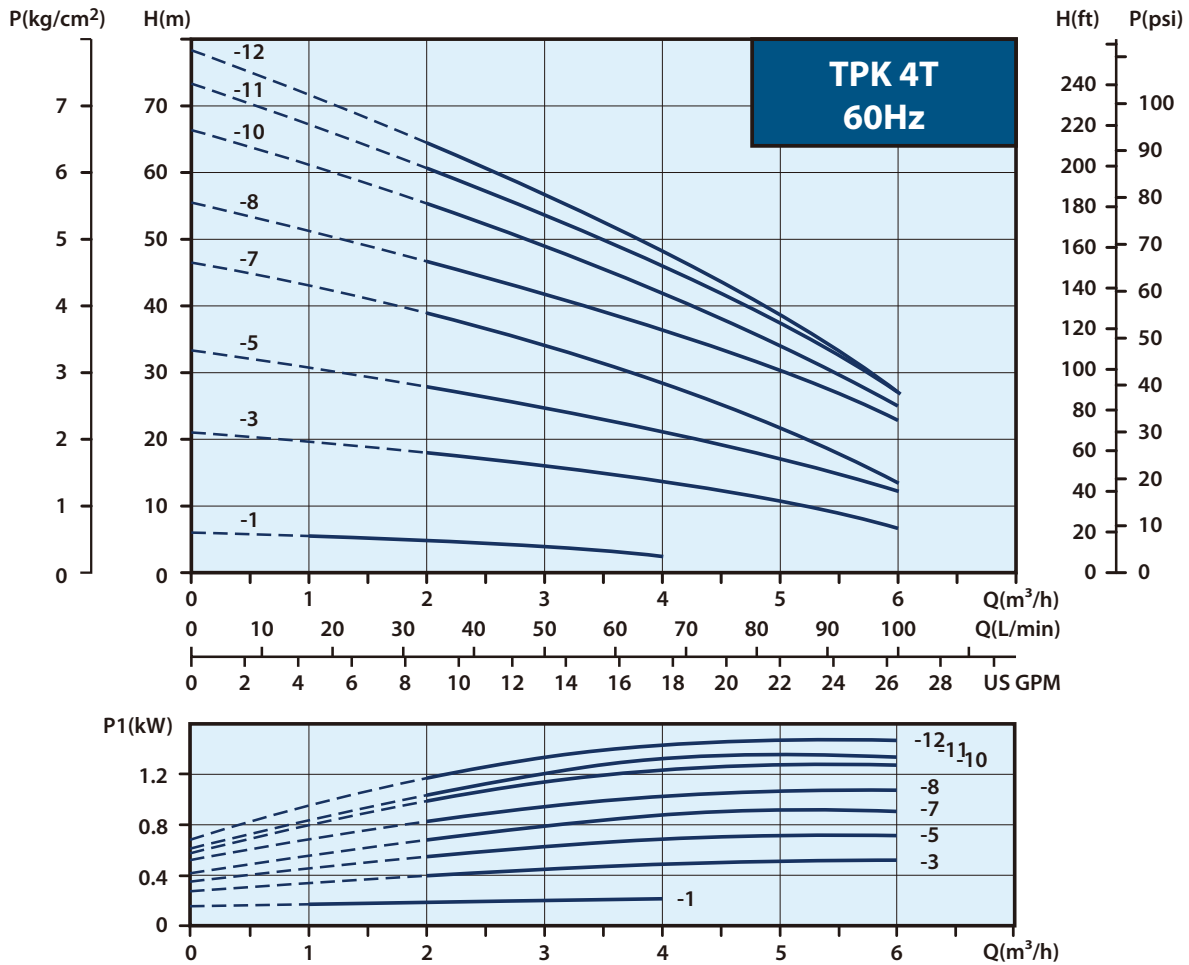

## Dimensions

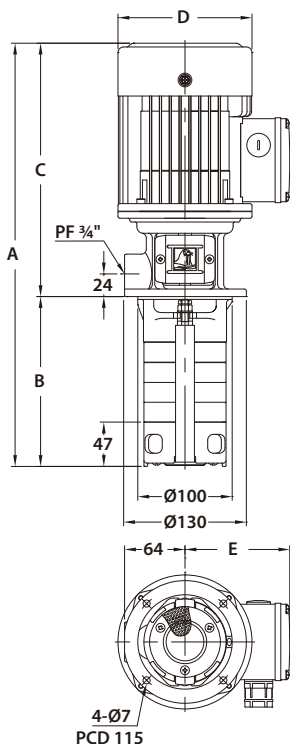

Model	A (mm)	B (mm)	C (mm)	D (mm)	E (mm)	N.W.(kg)
TPK4T 3 - 1	438	180	258	123	99	8.4
TPK4T 5 - 1	480	222	258	123	99	8.7
TPK4T 3 - 3	448	180	268	142	111	11.8
TPK4T 5 - 3	490	222	268	142	111	12.0
TPK4T 8 - 3	553	285	268	142	111	12.3
TPK4T 19- 3	784	516	268	142	111	13.4
TPK4T 5 - 5	490	222	268	142	111	12.1
TPK4T 8 - 5	553	285	268	142	111	12.4
TPK4T 11- 5	616	348	268	142	111	12.7
TPK4T 15- 5	700	432	268	142	111	13.0
TPK4T 19- 5	784	516	268	142	111	13.3
TPK4T 19- 7	824	516	308	142	111	14.8
TPK4T 8 - 8	593	285	308	142	111	13.8
TPK4T 11- 8	656	348	308	142	111	14.1
TPK4T 15- 8	740	432	308	142	111	14.4
TPK4T 19- 8	824	516	308	142	111	14.8
TPK4T 11-10	656	348	308	142	111	14.2
TPK4T 15-10	740	432	308	142	111	14.5
TPK4T 19-10	824	516	308	142	111	14.9
TPK4T 11-11	656	348	308	142	111	14.3
TPK4T 15-12	740	432	308	142	111	14.6
TPK4T 19-12	824	516	308	142	111	14.8
TPK4T 15-15	740	432	308	142	111	15.0
TPK4T 19-15	824	516	308	142	111	15.4



### Applications

The WALRUS TPK Series is vertical multistage centrifugal pump, designed for industrial use, specially for machine tools, to carry fluids such as water, coolant, light oil and other clean, non aggressive matters.

- Industrial circulation system
- Washing/cleaning system
- Filtration system

### Pump construction

Submersible vertical multistage centrifugal pump, self-priming, stub pump shaft per coupling connect with motor. Main working parts made by stainless steel.

### Motor

Enclosure class : IP54

Insulation class : F.

Nominal speed : 2900 / 3500 rpm

Frequency range : 50 / 60 Hz

Voltages Code:

Code	PH	50Hz	60Hz
3Q	3	200-240/380-440V	-
3Z*	3	200-255/380-440V	200-255/380-480V
4U*	3	200-240/380-415V	200-240/380-440V

\* The motor can be use in both 50/60 hz.

### Operation conditions

Ambient temperature :Max. +40°C

Liquid temperature range :+0°C ~ +90°C

Operating pressure :Max. 10 kg/cm<sup>2</sup>

Submerged depth :Min. 65mm

### Model code

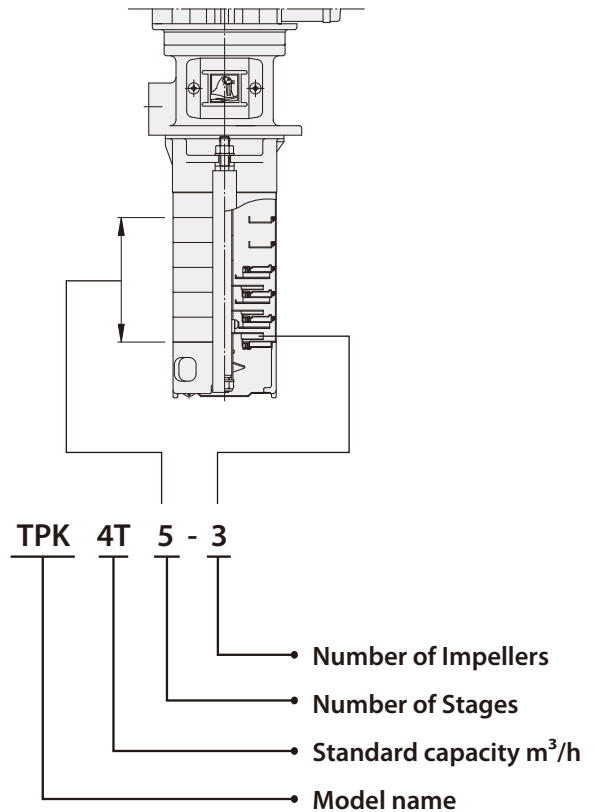

### Performance range

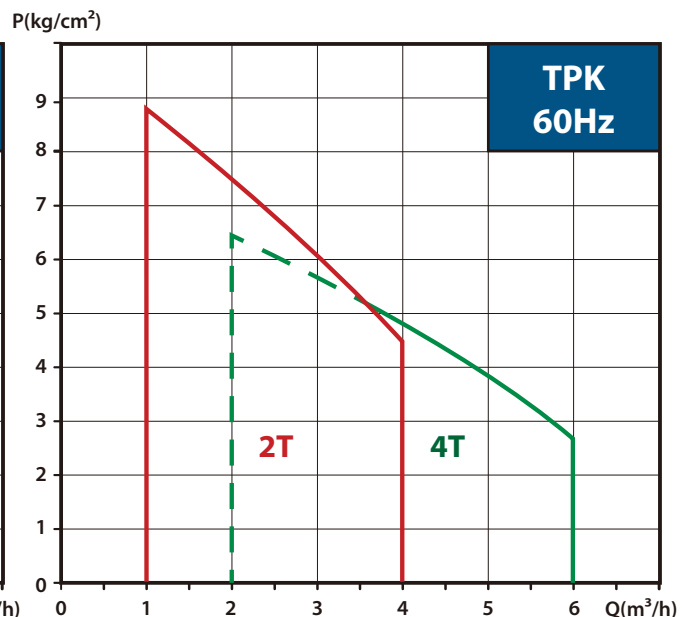
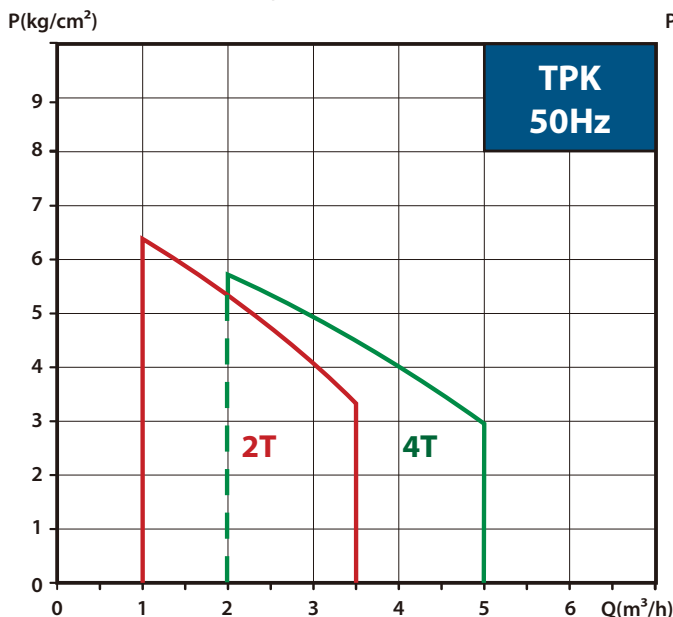



## Sectional drawing

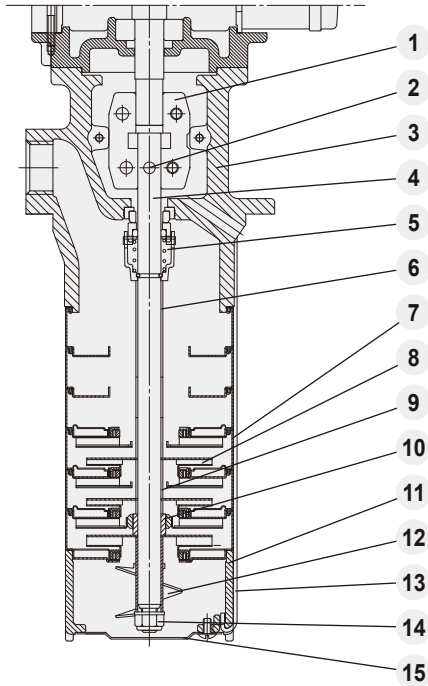

## Materials

No.	Part name	Material
1	Coupling	SUS 304
2	Shaft pin	SUS 304
3	Pump head	FCD 45
4	Shaft	SUS 304
5	Mechanical Seal	HTTH
6	Sleeve	SUS 304
7	Intermediate chamber	SUS 304
8	Impeller	SUS 304
9	Sleeve (impeller)	SUS 304
10	Bearing ring	Tungsten Carbide
11	Suction interconnector	SUS 304
12	Priming screw	SUS 304
13	Strap	SUS 304
14	Lock Nut	SUS 316
15	Filter	SUS 304

## Options on request

- Special mechanical seal

Mechanical seal type	Material	
	Stationary Face/ Rotary Face	Cup Gasket & O Ring
HTTH HTTV HTTE	(T)Tungsten Carbide/ (T)Tungsten Carbide	(H) HNBR (V) Viton (E) EPDM
HSSH HSSV HSSE	(S)Silicium carbide/ (S)Silicium carbide	
HGSH HGSV HGSE	(G)Carbon/ (S)Silicium carbide	

## Performance curves

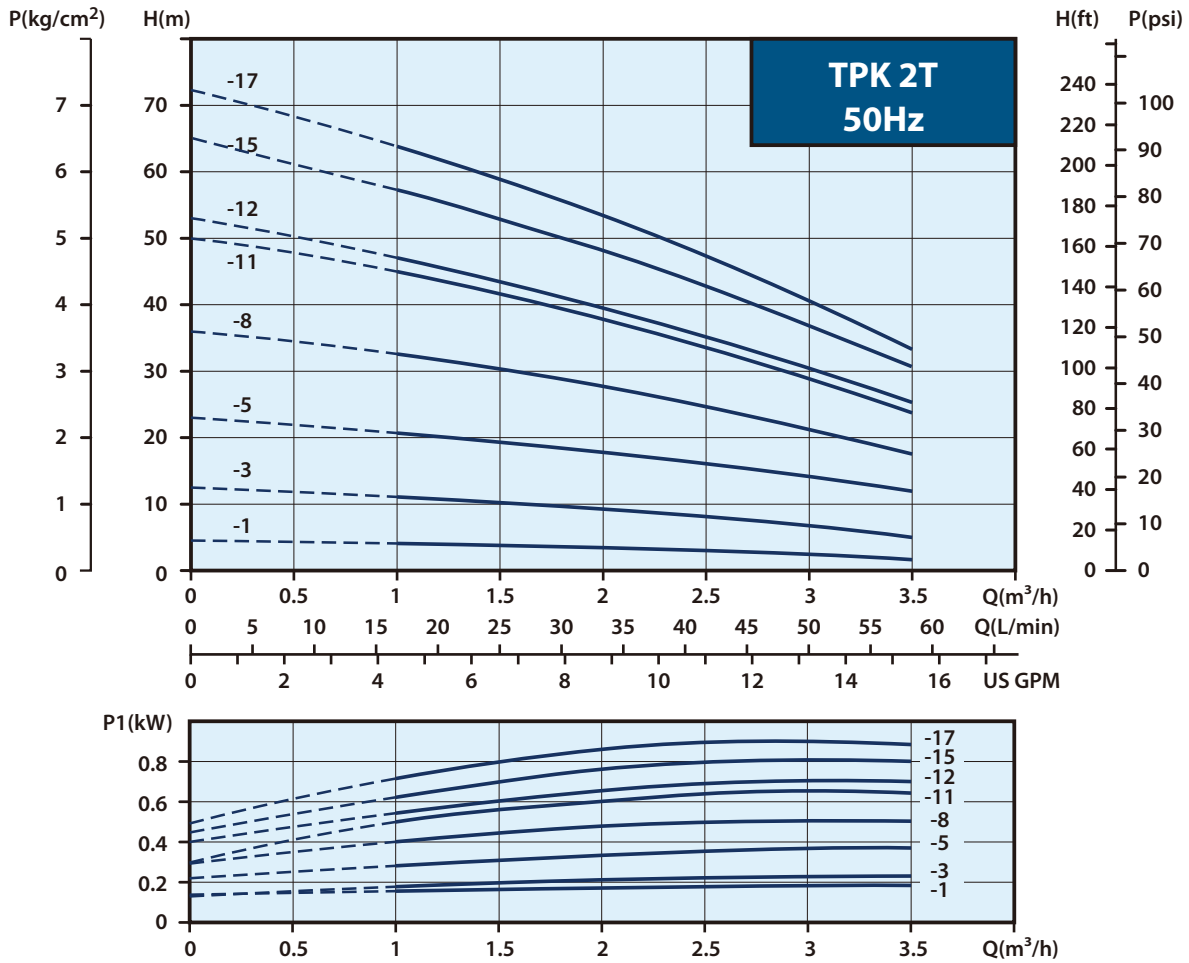

## Electrical data

Standard Model	Phase (Ø)	voltage code	Cycle (Hz)	Volts (V)	Input Power (W)	Input Ampere (A)
TPK 2T 3 - 1	3	3Z	50	200-255 / 380-440	220	0.9 / 0.6
			60	200-255 / 380-480	280	0.9 / 0.6
TPK 2T 3 - 3	3	3Z	50	200-255 / 380-440	280	0.9 / 0.7
			60	200-255 / 380-480	370	1.1 / 0.6
TPK 2T 5 - 5	3	3Z	50	200-255 / 380-440	450	2.6 / 1.5
			60	200-255 / 380-480	600	2.2 / 1.5
TPK 2T 8 - 8	3	3Z	50	200-255 / 380-440	580	2.9 / 1.7
			60	200-255 / 380-480	820	2.7 / 1.6
TPK 2T 11-11	3	3Z	50	200-255 / 380-440	700	3.2 / 1.8
			60	200-255 / 380-480	1050	3.5 / 1.9
TPK 2T 12-12	3	3Z	50	200-255 / 380-440	780	3.5 / 1.9
			60	200-255 / 380-480	1160	3.6 / 2.0
TPK 2T 15-15	3	4U	50	200-240 / 380-415	850	3.0 / 1.8
			60	200-240 / 380-440	1300	4.1 / 2.3
TPK 2T 17-17	3	4U	50	200-240 / 380-415	950	3.6 / 2.1
			60	200-240 / 380-440	1450	5.0 / 2.7

Maximum 19 Stages

## Performance curves

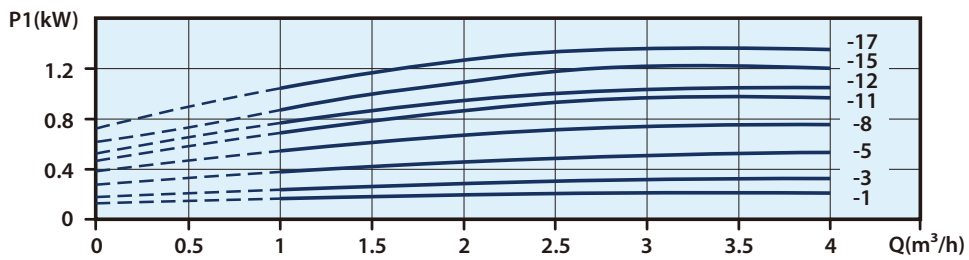
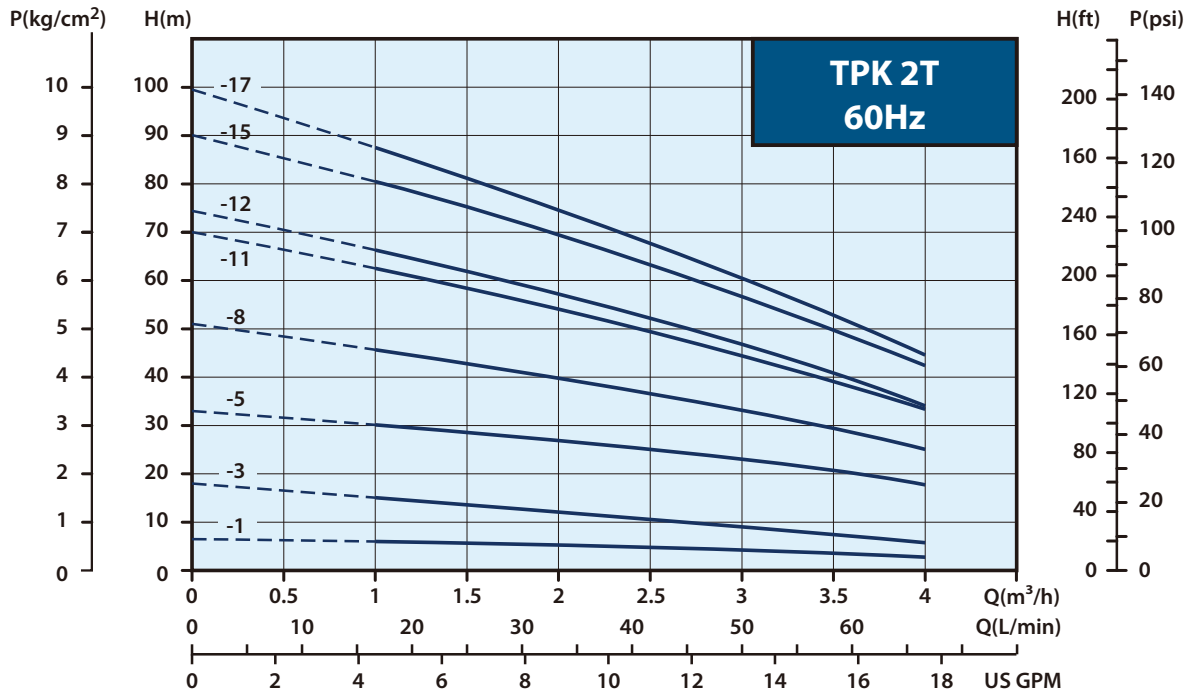

## Dimensions

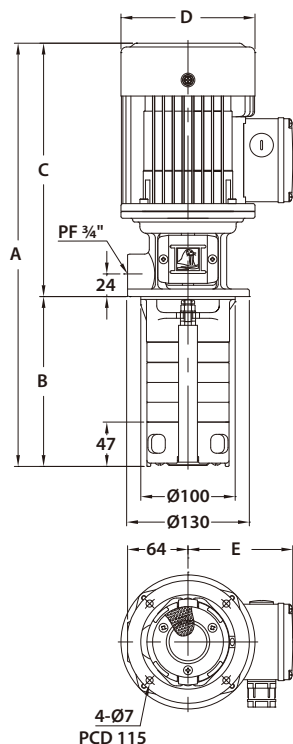

Model	A (mm)	B (mm)	C (mm)	D (mm)	E (mm)	N.W.(kg)
TPK2T 5 - 1	480	222	258	123	99	8.7
TPK2T 3 - 3	438	180	258	123	99	8.7
TPK2T 5 - 3	480	222	258	123	99	8.9
TPK2T 8 - 3	543	285	258	123	99	9.2
TPK2T 11 - 3	606	348	258	123	99	9.6
TPK2T 5 - 5	490	222	268	142	111	12.1
TPK2T 8 - 5	553	285	268	142	111	12.4
TPK2T 10 - 5	595	327	268	142	111	12.6
TPK2T 11 - 5	616	348	268	142	111	12.7
TPK2T 15 - 5	700	432	268	142	111	13.0
TPK2T 8 - 8	553	285	268	142	111	12.7
TPK2T 11 - 8	616	348	268	142	111	13.0
TPK2T 11-11	656	348	308	142	111	14.3
TPK2T 15-12	740	432	308	142	111	14.5
TPK2T 15-15	740	432	308	142	111	15.0
TPK2T 19-15	824	516	308	142	111	15.4
TPK2T 19-17	824	516	308	142	111	15.8

## Performance curves

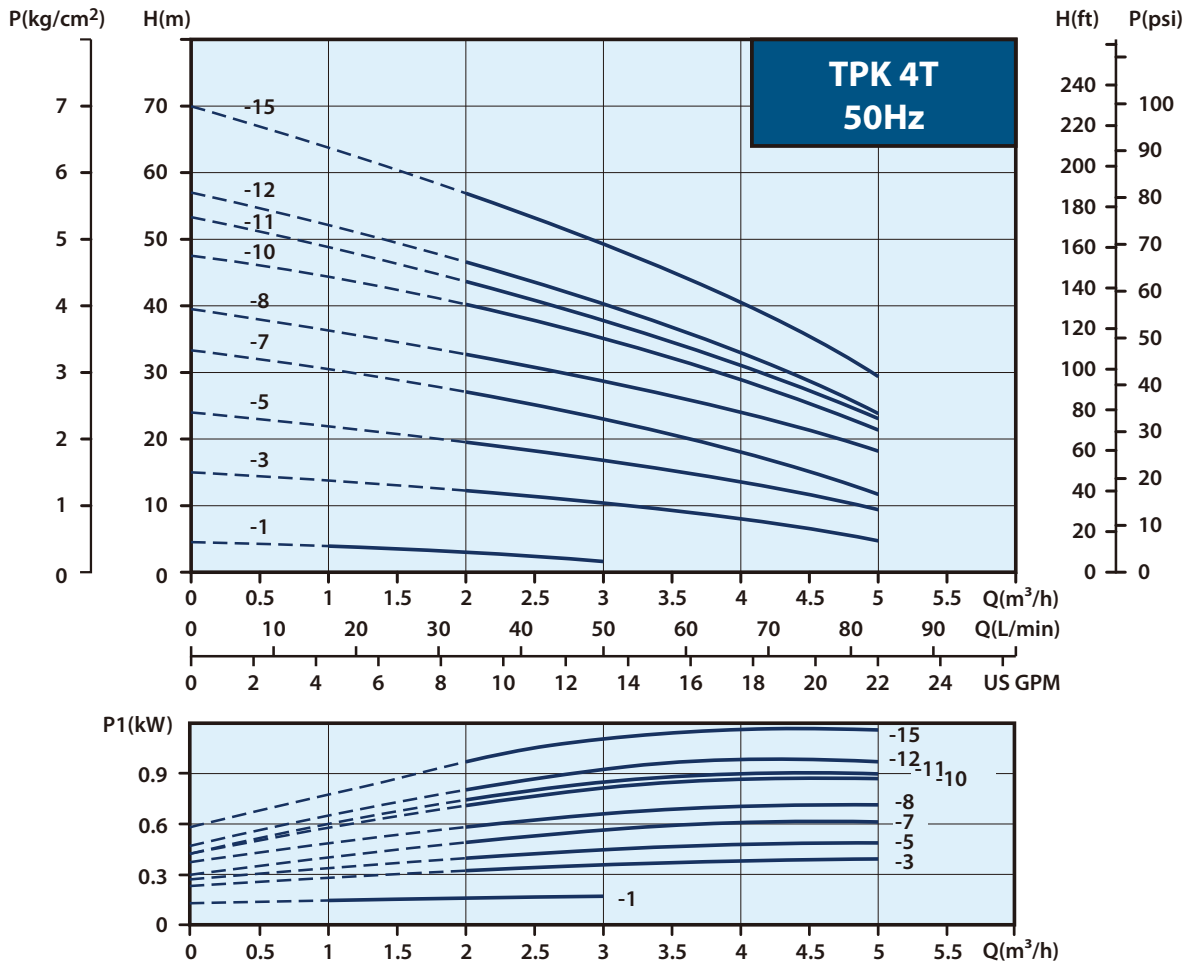

## Electrical data

Standard Model	Phase (Ø)	voltage code	Cycle (Hz)	Volts (V)	Input Power (W)	Input Ampere (A)
TPK 4T 3 - 1	3	3Z	50	200-255 / 380-440	250	1.0 / 0.6
			60	200-255 / 380-480	300	1.0 / 0.6
TPK 4T 3 - 3	3	3Z	50	200-255 / 380-440	430	2.8 / 1.4
			60	200-255 / 380-480	550	2.2 / 1.2
TPK 4T 5 - 5	3	3Z	50	200-255 / 380-440	580	2.9 / 1.7
			60	200-255 / 380-480	900	2.7 / 1.6
TPK 4T 7 - 7	3	3Z	50	200-255 / 380-440	680	3.2 / 1.8
			60	200-255 / 380-480	1000	3.4 / 1.9
TPK 4T 8 - 8	3	3Z	50	200-255 / 380-440	750	3.5 / 1.9
			60	200-255 / 380-480	1160	3.6 / 2.0
TPK 4T 10-10	3	3Z	50	200-255 / 380-440	900	4.7 / 2.6
			60	200-255 / 380-480	1420	4.7 / 2.6
TPK 4T 11-11	3	4U	50	200-240 / 380-415	950	3.6 / 2.1
			60	200-240 / 380-440	1450	5.0 / 2.7
TPK 4T 12-12	3	4U	50	200-240 / 380-415	1050	3.9 / 2.3
			60	200-240 / 380-440	1580	5.3 / 2.9
TPK 4T 15-15	3	3Q	50	200-240 / 380-440	1300	4.4 / 2.8

Maximum 19 Stages

## Performance curves

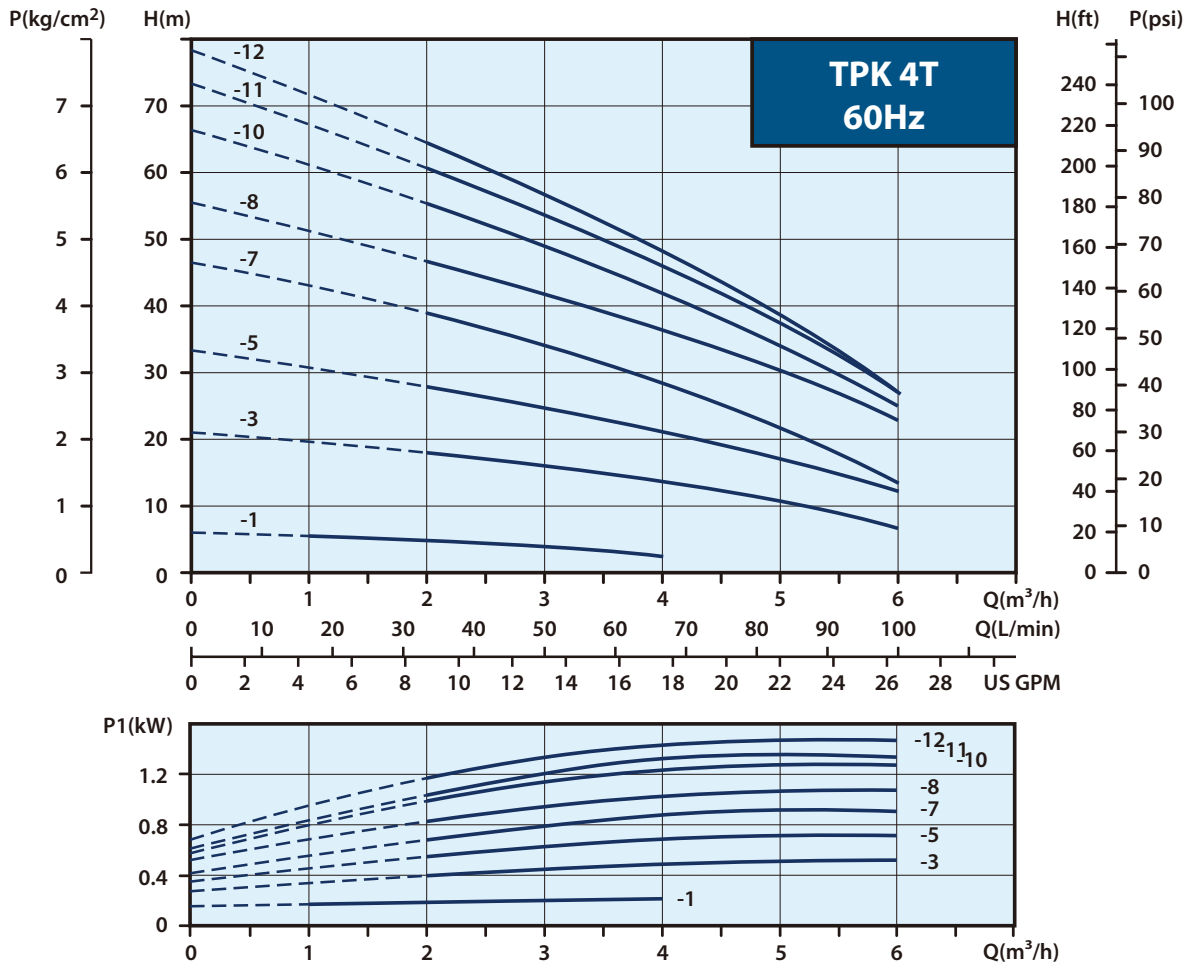

## Dimensions

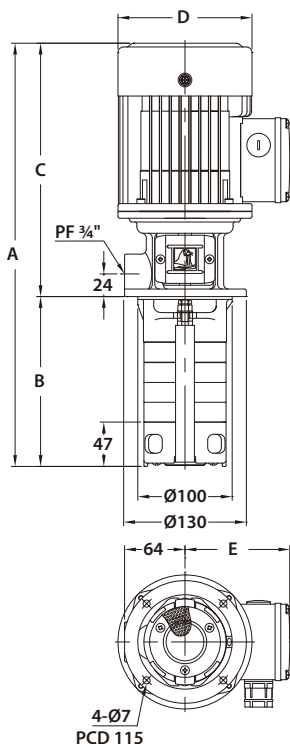

Model	A (mm)	B (mm)	C (mm)	D (mm)	E (mm)	N.W.(kg)
TPK4T 3 - 1	438	180	258	123	99	8.4
TPK4T 5 - 1	480	222	258	123	99	8.7
TPK4T 3 - 3	448	180	268	142	111	11.8
TPK4T 5 - 3	490	222	268	142	111	12.0
TPK4T 8 - 3	553	285	268	142	111	12.3
TPK4T 19- 3	784	516	268	142	111	13.4
TPK4T 5 - 5	490	222	268	142	111	12.1
TPK4T 8 - 5	553	285	268	142	111	12.4
TPK4T 11- 5	616	348	268	142	111	12.7
TPK4T 15- 5	700	432	268	142	111	13.0
TPK4T 19- 5	784	516	268	142	111	13.3
TPK4T 19- 7	824	516	308	142	111	14.8
TPK4T 8 - 8	593	285	308	142	111	13.8
TPK4T 11- 8	656	348	308	142	111	14.1
TPK4T 15- 8	740	432	308	142	111	14.4
TPK4T 19- 8	824	516	308	142	111	14.8
TPK4T 11-10	656	348	308	142	111	14.2
TPK4T 15-10	740	432	308	142	111	14.5
TPK4T 19-10	824	516	308	142	111	14.9
TPK4T 11-11	656	348	308	142	111	14.3
TPK4T 15-12	740	432	308	142	111	14.6
TPK4T 19-12	824	516	308	142	111	14.8
TPK4T 15-15	740	432	308	142	111	15.0
TPK4T 19-15	824	516	308	142	111	15.4